

Plat of Survey

of

Lot 33 of Charl-Mar Subdivision,

located in the Northwest 1/4 of the Northeast 1/4 of Section 1, Town 6 North,
Range 16 East, Town of Sugar Creek, Walworth County, Wisconsin.

Surveyed for: **Don & Connie Woolever**

W5066 Paddock Drive
Elkhorn, Wisconsin. 53121

Lot 38

Lot 37

Lot 39

Found iron pipe
0.91' N24°14'56"W of
rod at corner.

S89°59'23"E 149.38'
recorded as(N89°52'E 149.38')

recorded as(N89°52'E 195.00')
N89°49'49"E 195.23'

Found 2nd pipe
0.56' N1°03'43"E of
pipe at corner.

12' Wide Utility Easement
As shown on the plat of
Charl-Mar Subdivision.

Shed

Lot 33
Tax Parcel
GCH 00033

0.828 Acre
36,051 Sq.Ft.

House
W5066

Out-Lot 2
Private Park

N1°02'36"W 184.71'
recorded as(N0°58'W 185.00')

S0°58'57"E 184.83'
recorded as(N0°58'W 185.00')

Lot 34

Bearings referenced to the North line of
Paddock Drive, recorded as N89°52'E
on the plat of Charl-Mar Subdivision.

Paddock Drive
(66' Wide)

Found 2" dia. iron
pipe 2.80' N2°22'57"E
of corner.

recorded as(S89°52'W 97.60')
S89°52'00"W 97.60'

S89°52'00"W 195.04'
recorded as(N89°52'E 195.00')

S89°52'00"W 545.08'
recorded as(N89°52'E 543.84')

(195.00')
195.04'

(153.84')
155.00'

Paddock Drive
(66' Wide)

(Mary Lane)

Culvert

Well

Gas Meter

Elec. Meter

Fire Pit

Chain Link Fence

Deck

Wood Fence

66.03'

66.03'

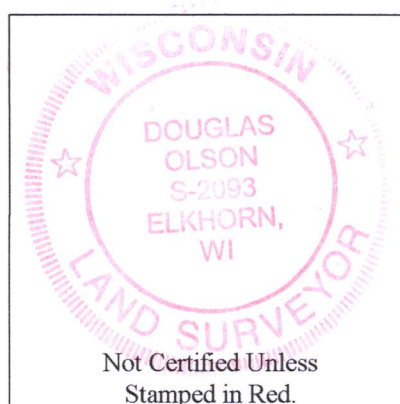

Notes:

- 1) This Plat of Survey is not certified unless signed and sealed in red ink.
- 2) This survey is subject to Wisconsin lien laws. This Plat of Survey is the notice of intent to file lien. Lien waiver required.
- 3) The Survey Date shown on this Plat of Survey is the completion date of the field work.

Copyright ©2018 by Olson Land Surveying, LLC.

All rights reserved. No part of this survey plat may be reproduced or transmitted in any form by any means - graphic, electronic, or mechanical, including photocopying, tracing, or information storage and retrieval systems - without permission in writing from Douglas G. Olson, Olson Land Surveying, LLC.

I hereby certify that I have surveyed the above described property in compliance with Chapter A-E 7 of the Wisconsin Administrative Code and that the map hereon is correct to the best of my professional knowledge and belief and shows the size and location of the property, its exterior boundaries, the location and dimensions of all visible structures thereon, boundary fences, apparent easements and roadways and visible encroachments, if any.

This survey is made for the exclusive use of the present owners of the property, and also those who purchase, mortgage or guarantee title thereto, within one year from the date hereof.

Douglas G. Olson
Wisconsin Professional Land Surveyor - 2093

GCH-33 3/6-2337

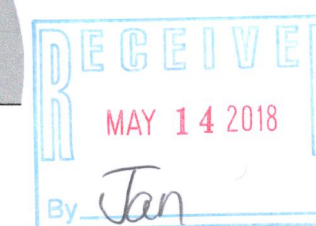

Survey Date: March 29, 2018.
Revisions:

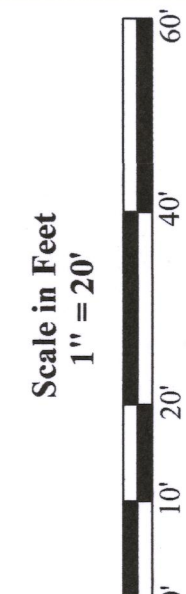

45 South Wisconsin Street | P.O. Box 322
Elkhorn, Wisconsin. 53121
Telephone: (262) 723-3434
Facsimile: (262) 723-8044
Email: doug@olsonsurveying.com
Website: www.olsonsurveying.com

OLSON
LAND SURVEYING, LLC
Rural | Residential | Commercial

Legend Symbols & Abbreviations
N North
S South
E East
W West
In Degrees
In Minutes
In Seconds
In Feet
In Inches
Found Iron Pipe, 2" diameter
Found Iron Pipe, 1" diameter
Found Iron Rod, 1" dia.
Recorded Information
Utility Box or Pedestal
Concrete Cover
Septic Vent
Septic Tank
Gravel Surface
Brick Pavers

Sheet 1 of 1 Sheets
Drawing Name
Job Reference Number
2018.027

2018.027